

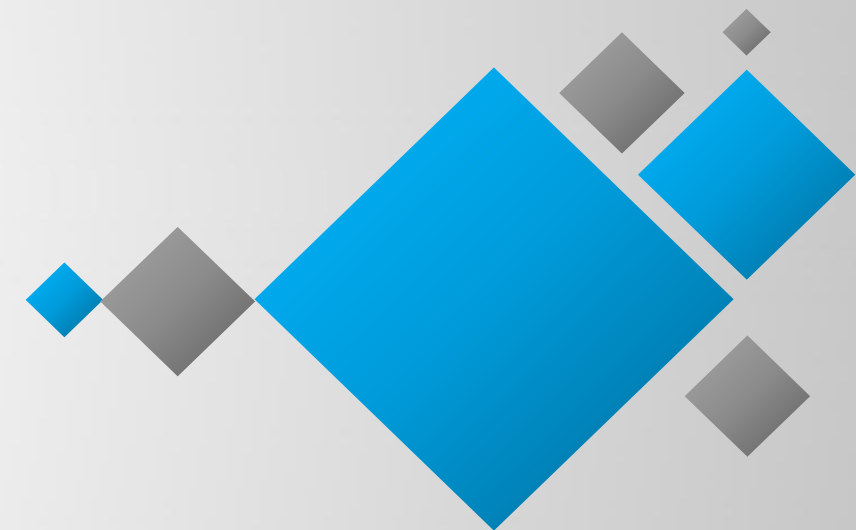

# GUOSE CONTAINER HOUSE



**Guangzhou office address :**

Room 311, Huayue Building, 423 Xicha Road, Baiyun District,  
Guangzhou City, Guangdong Province

**Factory address :**

No. 21, Linjiang Avenue, Yong'an Industrial Park, Dinghu District,  
Zhaoqing City, Guangdong Province



**Website:**

[www.steelmarkhouse.com](http://www.steelmarkhouse.com)  
[www.guosegroup.com](http://www.guosegroup.com)



| Focus | Quality | Honesty |

**Guangdong Guose Building Technology Group Co., LTD**

**Company contact : Shirley**

**Contact number : +86-13512762486**

Ordinary container, residential container, commercial container, Container toilet



# CONTENTS

## 01

### ABOUT US

- 1) Production lines
- 2) Enterprise honor
- 3) Construction drawing design

## 02

### CONTAINER HOUSE

- Expandable container:
- 1) More details
  - 2) Layout
  - 3) Project

- Detachable container:
- 1) More details
  - 2) Product installation
  - 3) Material
  - 4) Project
  - 5) Layout

- Corrugated container:
- 1) Project

- Flat pack container:
- 1) More details
  - 2) Project

- Folding container:
- 1) More details
  - 2) Project

# Located in China Headquartered in Zhaoqing, branch in Guangzhou **Modular housing**

Quality assurance and trustworthy

## OO ABOUT US

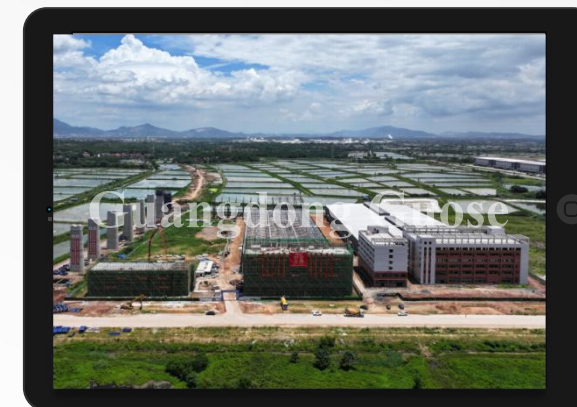

Guose is a professional company integrating design, production and after-sales service. The factory is located in Zhaoqing City, with a plant area of more than 100,000 square meters, and an outdoor exhibition hall of more than 30,000 square meters. It has more than 300 employees and 6 complete production lines, providing one-stop services from cutting, welding, production and processing, assembly, quality inspection to packaging, with an annual production capacity of more than 200 million yuan. In recent years, the company has continuously improved its own strength and service level. In addition to implementing the 1809001-2015 quality management system certification, it has continuously improved itself, met 5S standards and requirements, and obtained ISO9001, SGS, CE certification. First-class quality, efficient pre-sales and after-sales service have won a good reputation from customers all over the world, including the Middle East, Australia, Africa, Southeast Asia, Central America, etc.

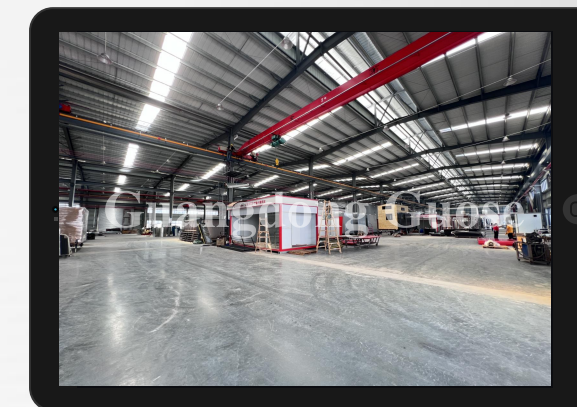

Guangdong Guose Building Technology Group Co., LTD established in 1996, started foreign trade business in 2011, and opened the first Alibaba foreign trade platform in 2013, specializing in the production of smart equipment. The main products include containers, shelters, light boxes, and signs. Brand, petrol station, antiaircraft artillery, solar stool, sentry box, quarantine channel, etc. Possess a series of top equipment and technical skills such as engraving, sheet metal, welding, laser cutting, water cutting, UV printing, spray coating, etc.



After 28 years of development, we have more than 300 employees, including designers, business personnel, production personnel and management personnel. With a diligent team and a harmonious working atmosphere, our products are becoming more and more perfect and diversified, with beautiful appearance and practicality. From project conception, design, manufacturing, construction to installation, we will try our best to provide customers with the most scientific, reasonable and effective solutions. Believe us, Guose container house is your first choice and the most ideal choice.

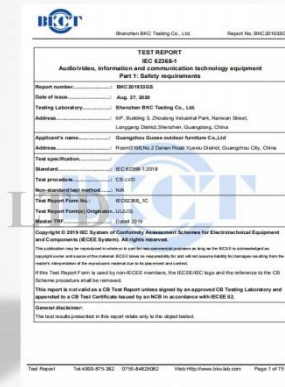
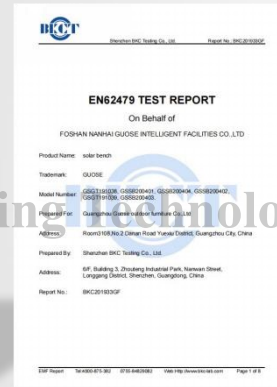
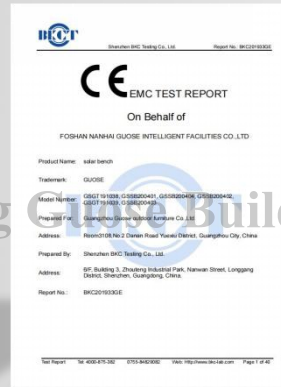

# CONSTRUCTION

We can design drawings according to customer requirements. It includes floor plan, three views, renderings and so on. Our engineers can also analyze the structure according to customer needs, and then further optimize the engineering drawings to save customer costs.

Drawing

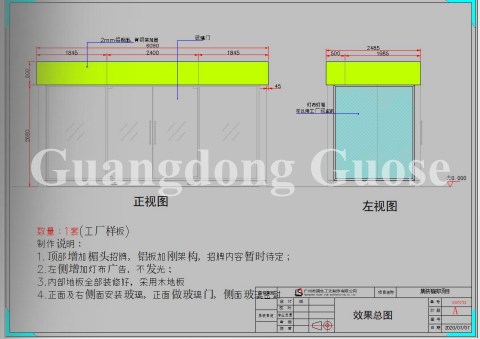
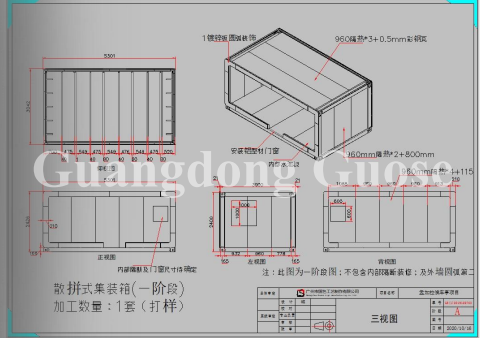
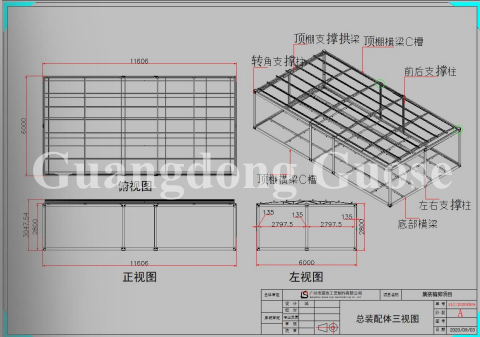

3D renderings



## Projects in Germany



## Projects in Türkiye



## Projects in Istanbul



## Projects in Türkiye





Reasonable design, can be used repeatedly

Cost saving, can be disassembled and re-used many times



The house design is beautiful and general, and the decoration effect is good

Wide application, can be used in construction sites, villas, resorts, schools, etc.

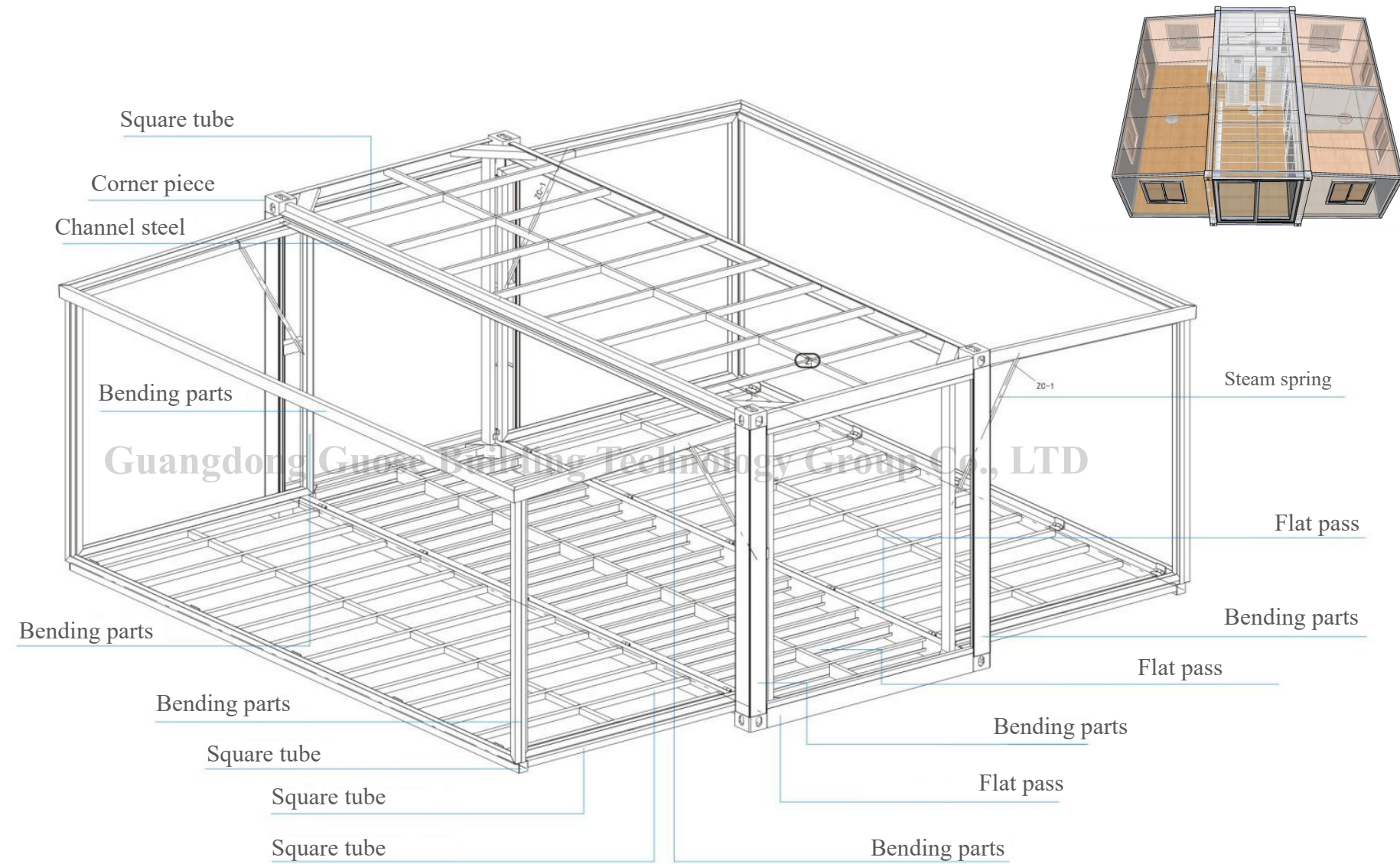

## Installation process



## Components

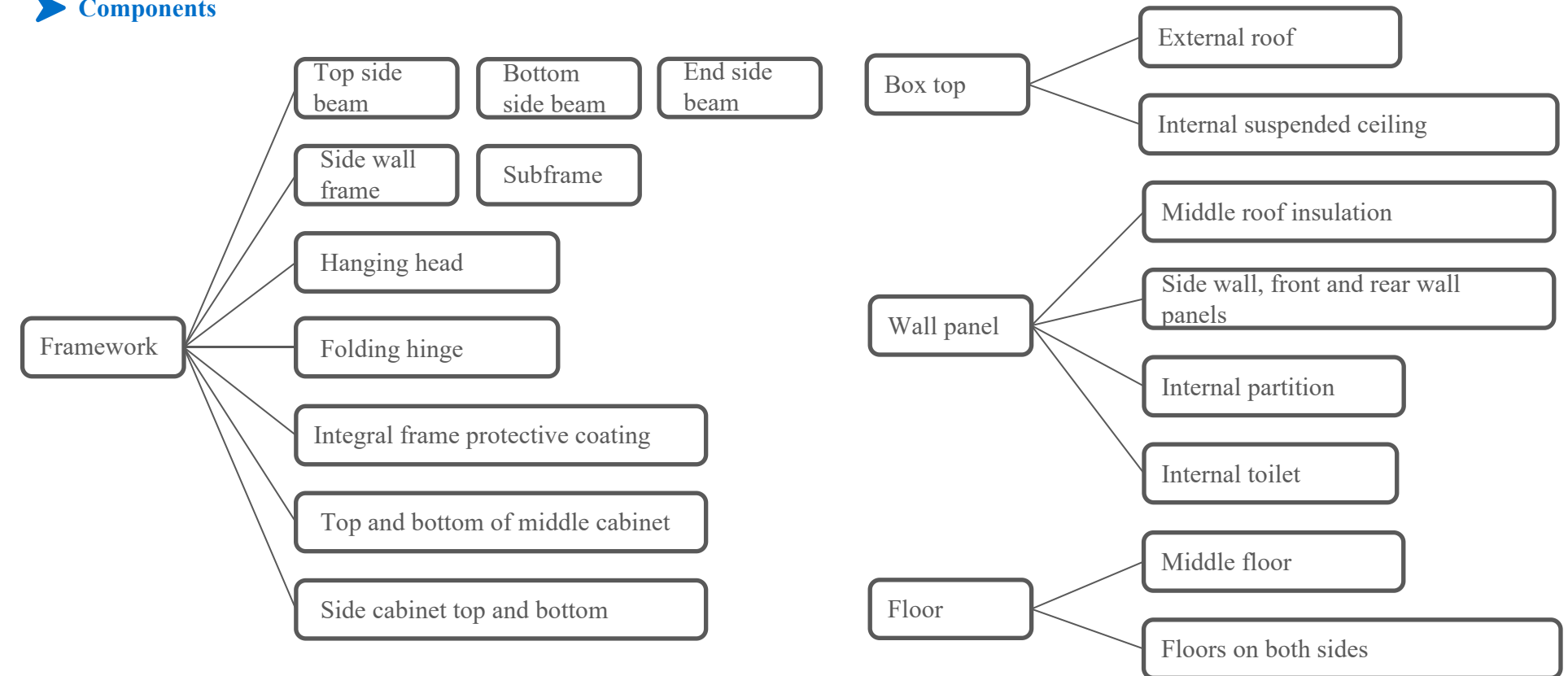



## ▶ TRANSPORTATION AND SHIPPING



## ▶ LAYOUT



**► 20 FEET LAYOUT**

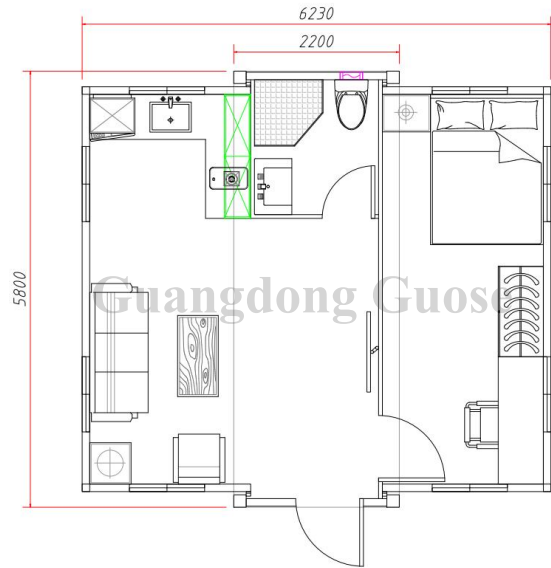

**Layout 1:**  
1 bedroom  
1 living room  
1 kitchen  
1 bathroom

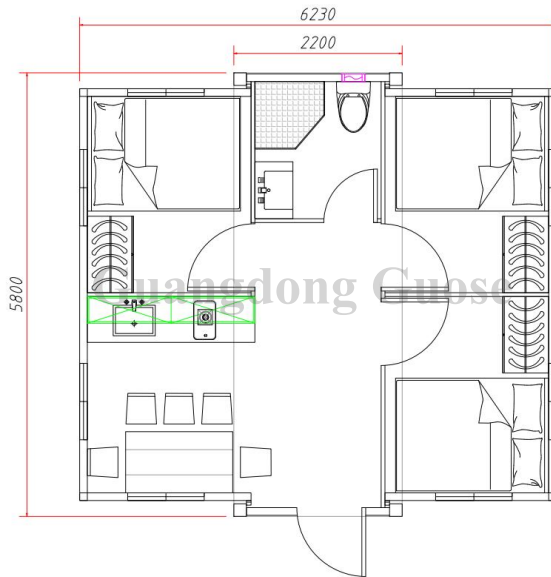

**Layout 1:**  
3 bedroom  
1 living room  
1 kitchen  
1 bathroom

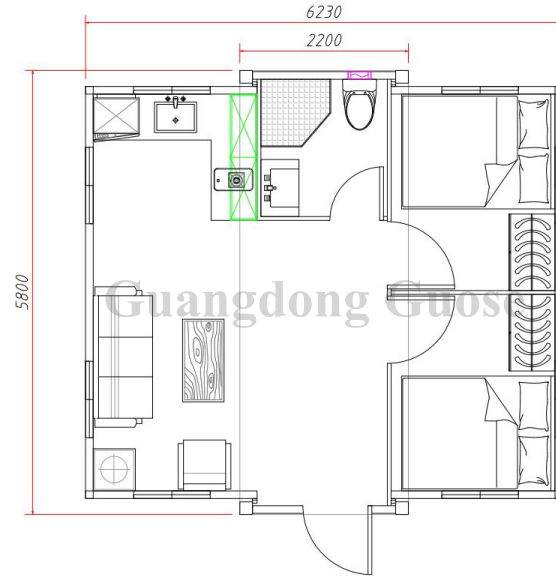

**Layout 2:**  
2 bedroom  
1 living room  
1 kitchen  
1 bathroom

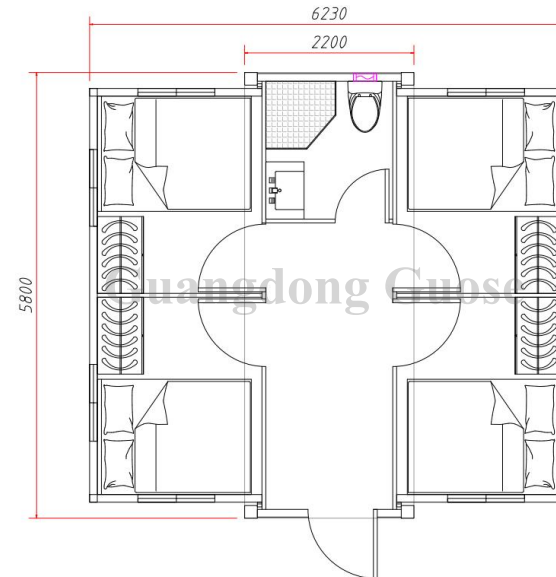

**Layout 2:**  
4 bedroom  
1 living room  
1 kitchen  
1 bathroom

**► 40 FEET LAYOUT**

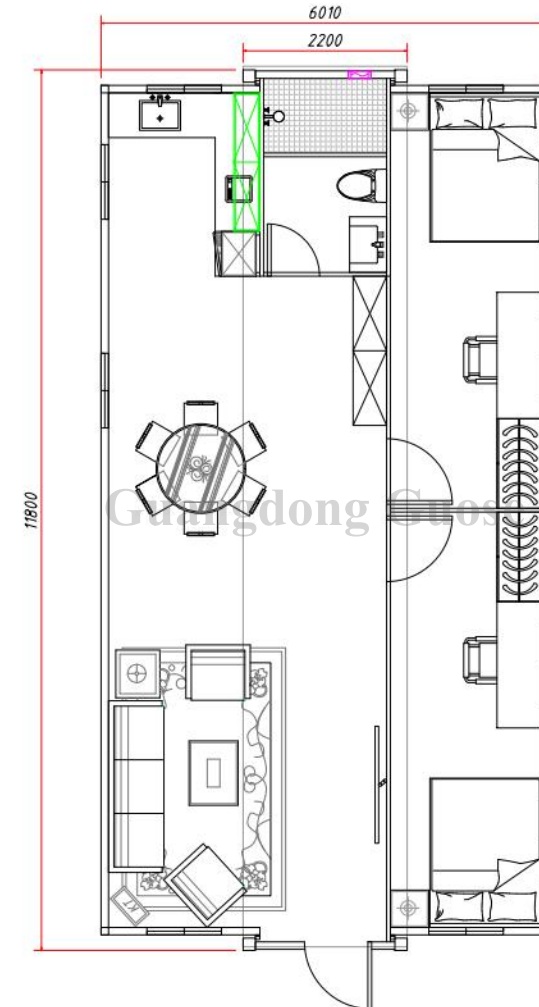

**Layout 1:**  
2 bedroom    1 living room  
1 kitchen    1 bathroom

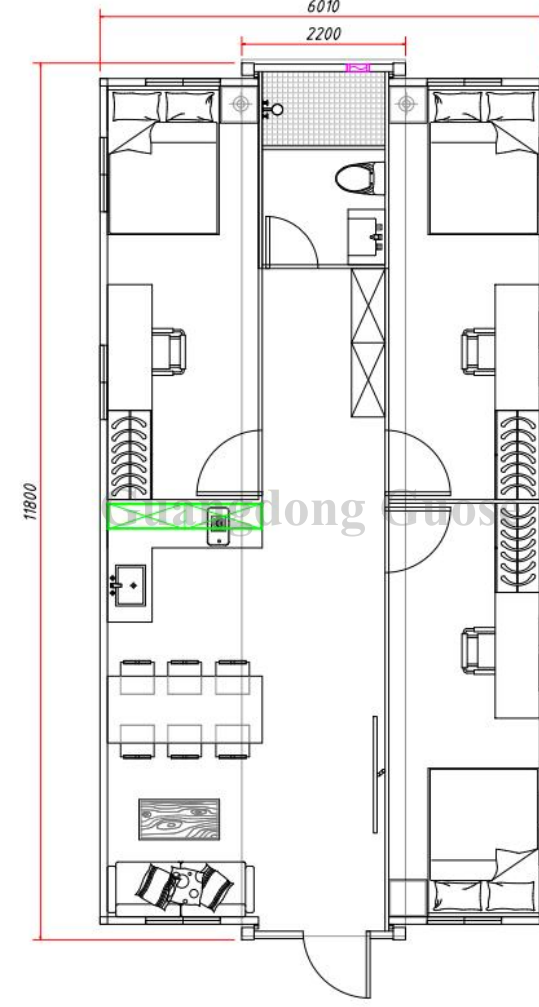

**Layout 2:**  
3 bedroom    1 living room  
1 kitchen    1 bathroom

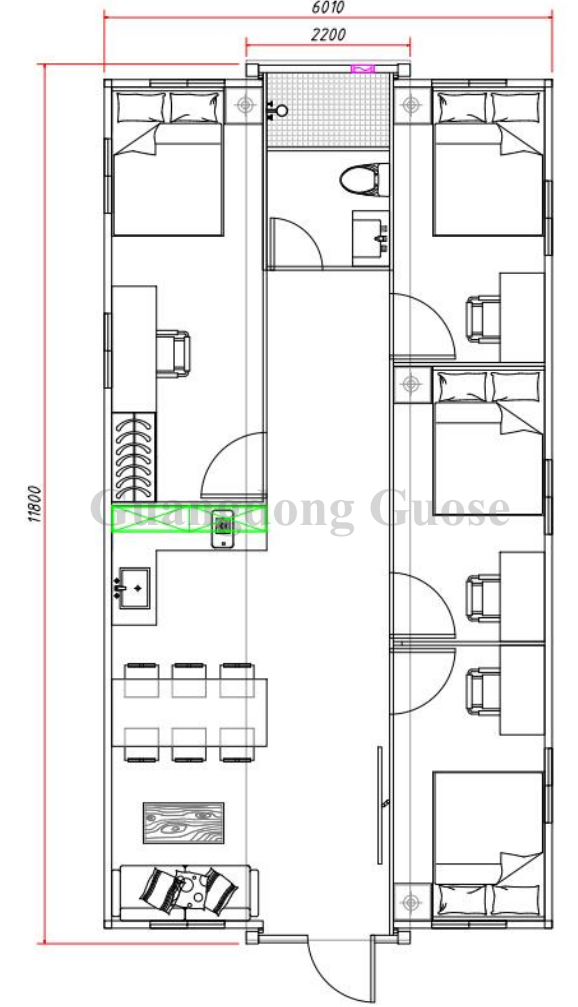

**Layout 2:**  
4 bedroom    1 living room  
1 kitchen    1 bathroom

# EXPANDABLE CONTAINER HOUSE

Compared with traditional buildings, container houses have shorter construction time, lower construction costs, and can be factory-produced, which greatly improves construction efficiency. One of the biggest advantages of container houses is that they can be recycled, which not only saves the generation of construction waste, but also makes full use of existing resources. In addition, container houses are also mobile and detachable, and their location and use can be changed at any time according to needs. They can be used for temporary accommodation, urban office, hotel tourism, etc.

In the future, container houses will still be an important part of green buildings. It can not only reduce resource consumption and environmental pollution, but also help improve energy efficiency and reduce carbon emissions. With the popularization of the concept of sustainable development and the enhancement of people's environmental awareness, the application prospects of container houses will be broader.



JE-01



JE-02



JE-03



JE-04



JE-05



JE-06



**JE-01**

**PRODUCT DESCRIPTION**

**20-foot specification**

Expanded size: L5800\*W6230\*H2500mm  
 Closed size: L5800\*W2200\*H2500mm

**40-foot specification**

Expanded size: L11800\*W6010\*H2500mm  
 Closed size: L11800\*W2200\*H2500mm

**Top:**

using 2.0mm steel plate + 50mm EPS color steel plate sandwich panel

**Bottom:**

channel steel structure frame + wooden plywood + PVC floor leather

**Wall panel:**

50mm EPS color steel sandwich panel

**Connection:**

stainless steel hinge

**Doors and windows:**

1 set of outward-opening aluminum alloy sliding doors + 8 sets of outward-opening aluminum alloy windows

**Bathroom:**

toilet x1, shower tray with shower head x1, wash basin with mirror x1, paper towel tube, clothes hook, soap rack x1

**Water and electricity circuit:**

power inlet box, leakage-proof distribution box, lighting, switch, socket, exhaust fan, lightning protection, hot and cold water inlet and outlet (according to each country's standards)

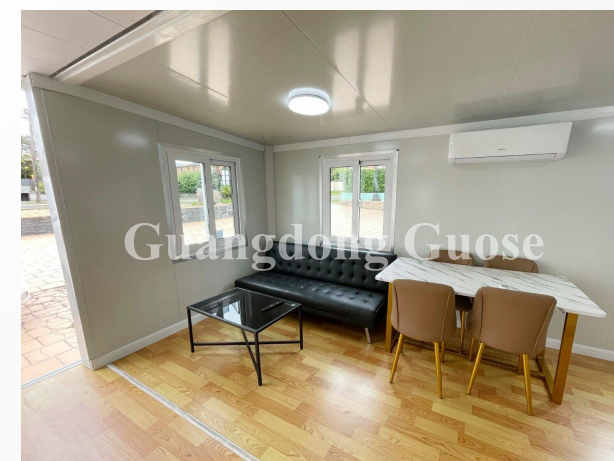



**JE-02**

**20-foot specification**

Expanded size: L5800\*W6230\*H2500mm  
 Closed size: L5800\*W2200\*H2500mm

**Top:** using 2.0mm steel plate + 50mm EPS color steel plate sandwich panel

**Bottom:** channel steel structure frame + wooden plywood + PVC floor leather

**Wall panel:** 50mm EPS color steel sandwich panel

**Connection:** stainless steel hinge

**Doors and windows:** 1 set of outward-opening aluminum alloy sliding doors + 8 sets of outward-opening aluminum alloy windows

**Bathroom:** toilet x1, shower tray with shower head x1, wash basin with mirror x1, paper towel tube, clothes hook, soap rack x1

**Water and electricity circuit:** power inlet box, leakage-proof distribution box, lighting, switch, socket, exhaust fan, lightning protection, hot and cold water inlet and outlet (according to each country's standards)

**40-foot specification**

Expanded size: L11800\*W6010\*H2500mm  
 Closed size: L11800\*W2200\*H2500mm





**JE-03**

**20-foot specification**

Expanded size: L5800\*W6230\*H2500mm  
 Closed size: L5800\*W2200\*H2500mm

**Top:** using 2.0mm steel plate + 50mm EPS color steel plate sandwich panel

**Bottom:** channel steel structure frame + wooden plywood + PVC floor leather

**Wall panel:** 50mm EPS color steel sandwich panel

**Connection:** stainless steel hinge

**Doors and windows:** 1 set of outward-opening aluminum alloy sliding doors + 8 sets of outward-opening aluminum alloy windows

**Bathroom:** toilet x1, shower tray with shower head x1, wash basin with mirror x1, paper towel tube, clothes hook, soap rack x1

**Water and electricity circuit:** power inlet box, leakage-proof distribution box, lighting, switch, socket, exhaust fan, lightning protection, hot and cold water inlet and outlet (according to each country's standards)

**40-foot specification**

Expanded size: L11800\*W6010\*H2500mm  
 Closed size: L11800\*W2200\*H2500mm





**JE-04**

**PRODUCT DESCRIPTION**

**20-foot specification**

Expanded size: L5800\*W6230\*H2500mm  
 Closed size: L5800\*W2200\*H2500mm

**40-foot specification**

Expanded size: L11800\*W6010\*H2500mm  
 Closed size: L11800\*W2200\*H2500mm

**Top:**

using 2.0mm steel plate + 50mm EPS color steel plate sandwich panel

**Bottom:**

channel steel structure frame + wooden plywood + PVC floor leather

**Wall panel:**

50mm EPS color steel sandwich panel

**Connection:**

stainless steel hinge

**Doors and windows:**

1 set of outward-opening aluminum alloy sliding doors + 8 sets of outward-opening aluminum alloy windows

**Bathroom:**

toilet x1, shower tray with shower head x1, wash basin with mirror x1, paper towel tube, clothes hook, soap rack x1

**Water and electricity circuit:**

power inlet box, leakage-proof distribution box, lighting, switch, socket, exhaust fan, lightning protection, hot and cold water inlet and outlet (according to each country's standards)





**JE-05**

**PRODUCT DESCRIPTION**

**20-foot specification**

Expanded size: L5800\*W6230\*H2500mm  
 Closed size: L5800\*W2200\*H2500mm

**40-foot specification**

Expanded size: L11800\*W6010\*H2500mm  
 Closed size: L11800\*W2200\*H2500mm

**Top:**

using 2.0mm steel plate + 50mm EPS color steel plate sandwich panel

**Bottom:**

channel steel structure frame + wooden plywood + PVC floor leather

**Wall panel:**

50mm EPS color steel sandwich panel

**Connection:**

stainless steel hinge

**Doors and windows:**

1 set of outward-opening aluminum alloy sliding doors + 8 sets of outward-opening aluminum alloy windows

**Bathroom:**

toilet x1, shower tray with shower head x1, wash basin with mirror x1, paper towel tube, clothes hook, soap rack x1

**Water and electricity circuit:**

power inlet box, leakage-proof distribution box, lighting, switch, socket, exhaust fan, lightning protection, hot and cold water inlet and outlet (according to each country's standards)

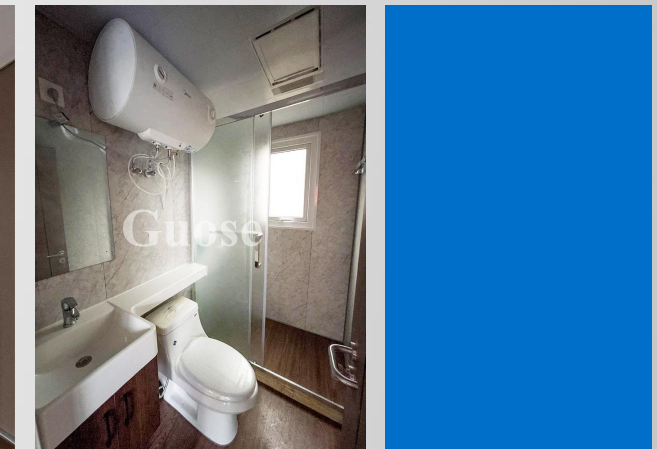





**JE-05-01**

**PRODUCT DESCRIPTION**

**20-foot specification**

Expanded size: L5800\*W6230\*H2500mm  
 Closed size: L5800\*W2200\*H2500mm

**40-foot specification**

Expanded size: L11800\*W6010\*H2500mm  
 Closed size: L11800\*W2200\*H2500mm

**Top:**

using 2.0mm steel plate + 50mm EPS color steel plate sandwich panel

**Bottom:**

channel steel structure frame + wooden plywood + PVC floor leather

**Wall panel:**

50mm EPS color steel sandwich panel

**Connection:**

stainless steel hinge

**Doors and windows:**

1 set of outward-opening aluminum alloy sliding doors + 8 sets of outward-opening aluminum alloy windows

**Bathroom:**

toilet x1, shower tray with shower head x1, wash basin with mirror x1, paper towel tube, clothes hook, soap rack x1

**Water and electricity circuit:**

power inlet box, leakage-proof distribution box, lighting, switch, socket, exhaust fan, lightning protection, hot and cold water inlet and outlet (according to each country's standards)





**JE-06**

**PRODUCT DESCRIPTION**

**20-foot specification**

Expanded size: L5800\*W4215\*H2500mm  
 Closed size: L5800\*W2200\*H2500mm

**40-foot specification**

Expanded size: L11800\*W4215\*H2500mm  
 Closed size: L11800\*W2200\*H2500mm

**Top:**

using 2.0mm steel plate + 50mm EPS color steel plate sandwich panel

**Bottom:**

channel steel structure frame + wooden plywood + PVC floor leather

**Wall panel:**

50mm EPS color steel sandwich panel

**Connection:**

stainless steel hinge

**Doors and windows:**

1 set of outward-opening aluminum alloy sliding doors + 4 sets of outward-opening aluminum alloy windows

**Bathroom:**

toilet x1, shower tray with shower head x1, wash basin with mirror x1, paper towel tube, clothes hook, soap rack x1

**Water and electricity circuit:**

power inlet box, leakage-proof distribution box, lighting, switch, socket, exhaust fan, lightning protection, hot and cold water inlet and outlet (according to each country's standards)



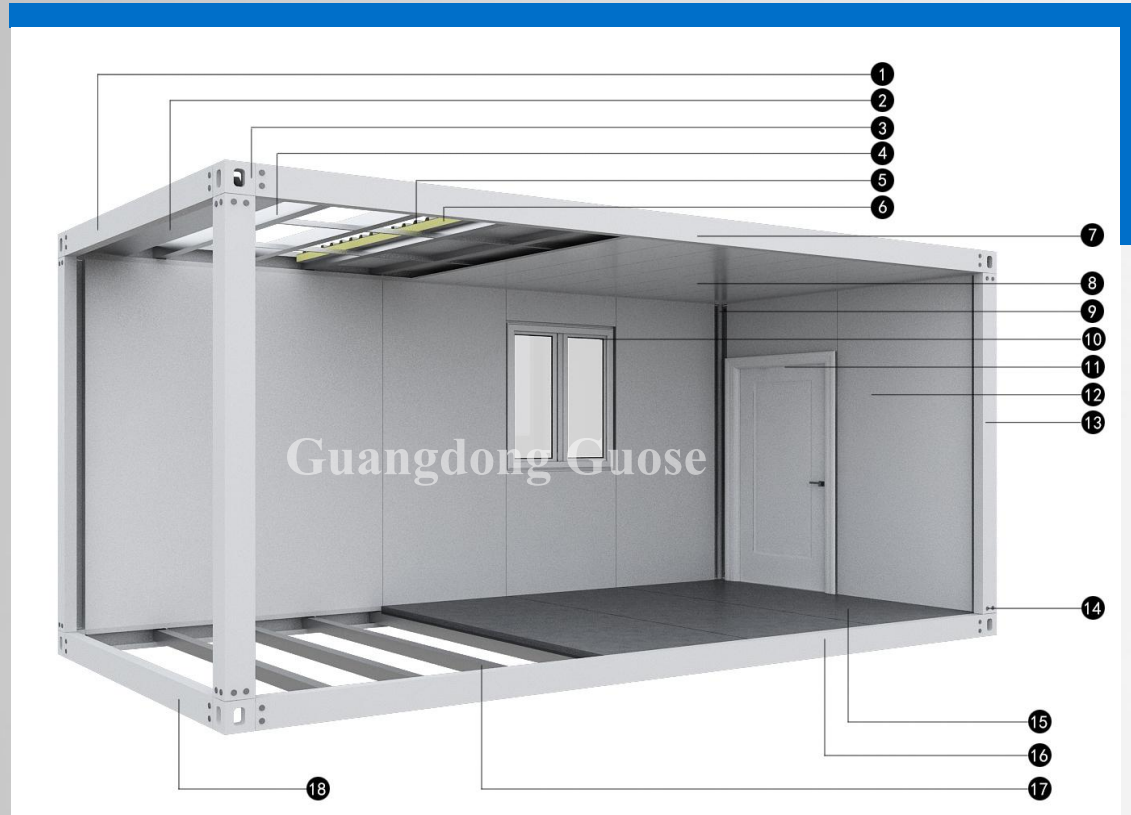

Guangdong Guose

- |                           |                        |
|---------------------------|------------------------|
| ① Top short beam          | ⑩ Window               |
| ② Top drain               | ⑪ Door                 |
| ③ Angle head              | ⑫ Rock wool wall panel |
| ④ Top square tube         | ⑬ Prism                |
| ⑤ Outer top tile          | ⑭ Screw                |
| ⑥ Glass wool roll         | ⑮ Cement fiberboard    |
| ⑦ Top long beam           | ⑯ Bottom long beam     |
| ⑧ 831 color steel ceiling | ⑰ Bottom square tube   |
| ⑨ Drain pipe              | ⑱ Bottom short beam    |

## DETACHABLE CONTAINER

## HIGH QUALITY, EASY TO INSTALL AND TRANSPORT, CAN BE CUSTOMIZED

Product name	Fast LCL
Size	5950*3000*2800mm
Ground load-bearing	250kg/SQM
Roof load-bearing	100kg/SQM
Service life	More than 20 years
Corner material	Steel
Corner post material	Steel
Top/bottom beam material	Steel
Wall	Rock wool board
Roof	Outer top tile
Door	Aluminum alloy door/plastic steel door/stainless steel door
Window	Plastic steel window/aluminum alloy window
Floor	Cement fiber board/Glass magnesium board



- |                            |                              |
|----------------------------|------------------------------|
| ✓ Waterproof and windproof | ✓ Beautiful and changeable   |
| ✓ The modular unit         | ✓ Stable and durable         |
| ✓ Easy to assemble         | ✓ High quality and low price |



**Guose Container house,  
comfortable and  
beautiful, bring you a  
different life**

## PROJECT

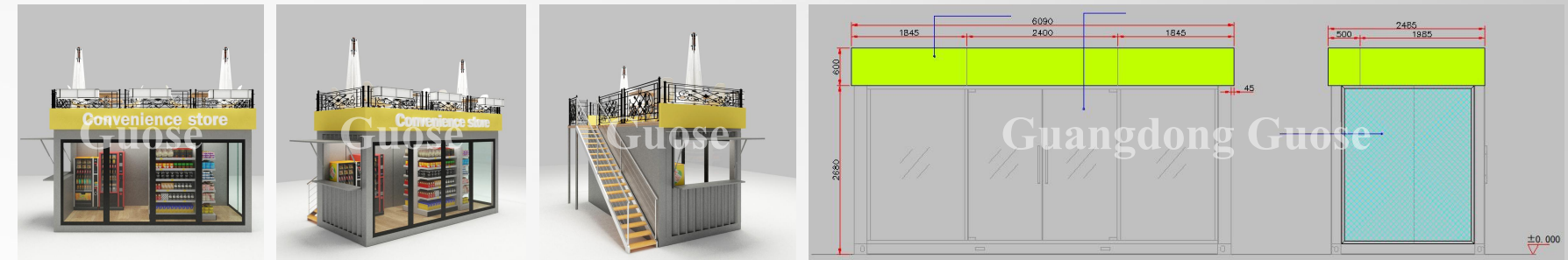

## CONTAINER SHOPS

The advantage of using containers as shops is that they can be easily moved to various places suitable for business operations, and it is convenient for operators to place shops according to the flow of people. On the other hand, the eye-catching shape of container shops will be easier to attract customers' attention, which is suitable for gas stations, service areas, commercial streets and other places, and container shops are cheap and cost-effective.

## RESTAURANT

Model number: JZXF200703

Guose Containers are sold abroad, integrating product research and development, design, standard container production, product customization, sales, and after-sales. We are committed to providing customers with high-quality, cost-effective residential and commercial space solutions.



## ISOLATION CAMP

Model number: 2020122805

The interior of the isolation camp is divided into two independent rooms, and the toilets are respectively configured, which effectively plays the role of isolation and protection





## SMALL MALL

Model number:  
JZXF200862-GS(1)2020123007

The small shopping mall is composed of 6 containers connected together. In addition, the front has a decorative panel and a display screen, which is beautiful and atmospheric.



## BAKERY SHOP

Model number: GS (1) 2020120404

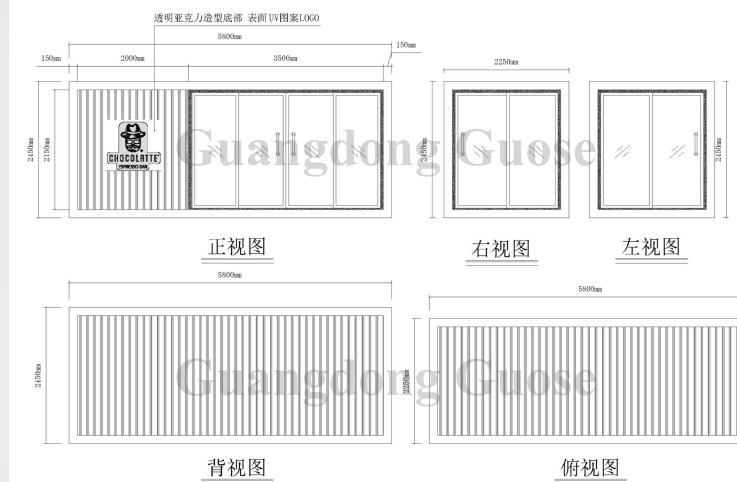

# MEETING ROOM



# FRENCH CONTAINER PROJECT



## CONTAINER HOUSE

Using the combination of bottom two on top, three containers are combined. The first floor is the living room and the kitchen, the second floor is the bedroom and the balcony, and the balcony is composed of railings on the top of the first floor container, which can maximize the use of space. , There is also an outdoor staircase at the back, so that you can go up to the bedroom on the second floor. In addition, the outer wall is made of wood grain decorative panels, which makes the whole appearance to a higher level.

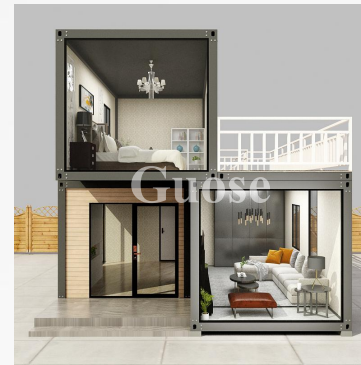

## CONTAINER OFFICE

The office is composed of six 20-foot containers. The outer wall is made of corrugated boards, and the doors and windows are made of glass sliding doors and floor-to-ceiling glass windows, making the field of vision broad. There are managers' rooms and staff offices on the first floor, conference rooms and lounges on the second floor, and a large balcony for employees to rest and activities. In addition, there is a corridor on the first floor to keep out the wind, rain and sun.





**One-piece house**

Model number: GS(1)2021062501

The exterior wall decoration panel of corrugated board is adopted, which will be more distinctive and more attractive than ordinary flat panels.

The interior is equipped with areas such as bathroom, kitchen, bath, toilet, and bedroom.

The doors and windows adopt hydraulic windows, floor-to-ceiling glass windows, sliding glass doors, and hydraulic doors.

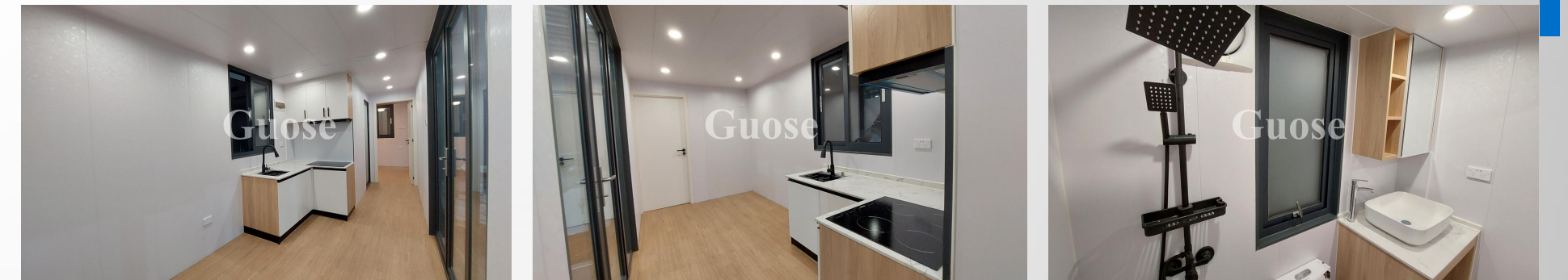

**Houses in New Zealand**

New Zealand 40 feet container room, the internal layout is comfortable and reasonable, there are 2 rooms, a living room, a kitchen, a toilet, can meet the living needs of 4-5 people

# CAFE (HYDRAULIC VERSION)



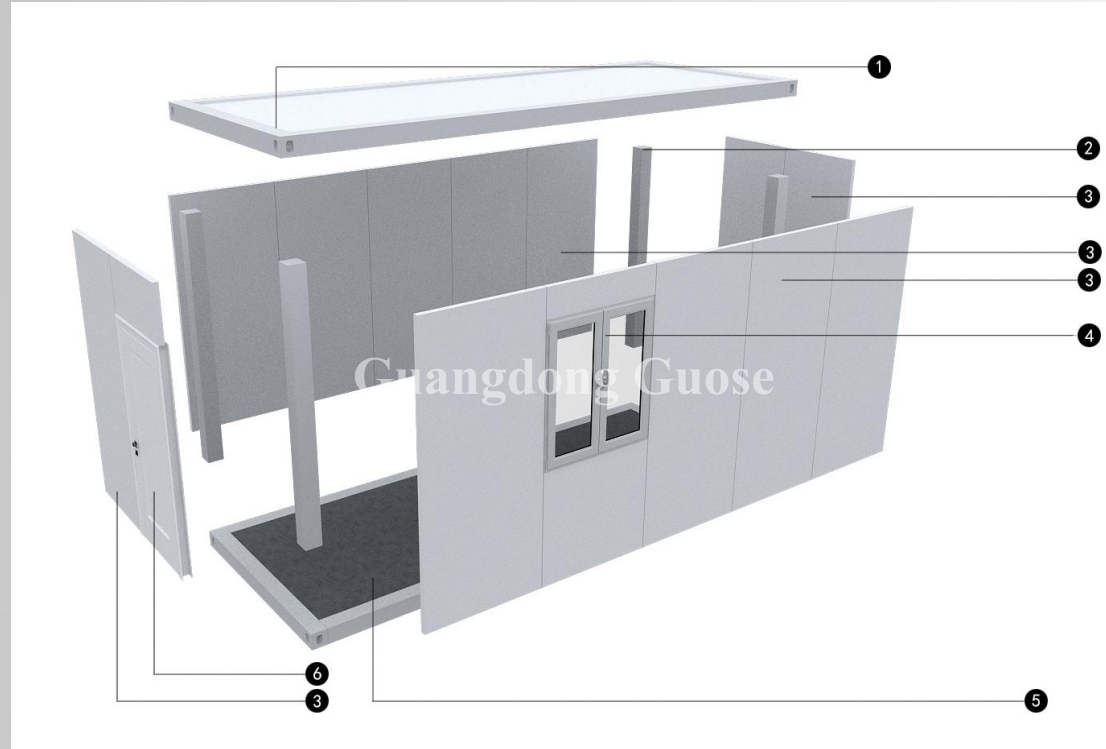

- 1 Top (roof)**      **2 Container post**      **3 Rock wool board**
- 4 Window**      **5 Bottom (floor)**      **6 Door**

- 1** our product ,the roof and floor are the standalone block,including reserved wire. no need you to fit parts in site.
- 2** put the floor frame on the flat place,then use the hexagon socket screw to fit the columns.
- 3** use the hexagon socket screw to fit the the roof frame to columns.
- 4** To install the wall panels, we use high-quality rock wool panels
- 5** To install the wall panels, we use high-quality rock wool panels
- 6** Install window frames and windows
- 7** Install the door to complete the overall installation
- 8** Install the door to complete the overall installation

**PACKING BOX**

Packing boxes are a new generation of prefabricated houses. It is an integral unit in itself, which can be used as a single portable house, or it can be combined horizontally or stacked to two or three floors. The packing box house can be connected by bolts, which is easy to install and fast to transport. The life span is about 15-20 years.



*A variety of styles, more affordable and more convenient*

<b>Product name</b>	Packing box
<b>Product Size</b>	5800*2250*2800mm
<b>Thermal insulation</b>	$\lambda=0.048W/m \cdot K$
<b>Sound insulation performance</b>	Sound insulation $\geq 30dB$
<b>Waterproof performance</b>	360-degree bite, organized drainage, 16mm/min precipitation, no leakage
<b>Ground live load</b>	2.0kN/m <sup>2</sup>
<b>Wind resistance</b>	0.60kN/m <sup>2</sup>
<b>Fire performance</b>	Class A
<b>Seismic performance</b>	Level 8
<b>Roof live load</b>	1.0kN/m <sup>2</sup>
<b>Gate</b>	Packing box door
<b>Window</b>	Plastic steel window/ aluminum alloy window
<b>Floor</b>	Cement fiber board/ Glass magnesium board



## CONTAINER HOUSE

There are many exterior wall styles of residential containers, which can be selected according to personal preferences. The installation of solar energy devices on the top truly achieves environmental protection and energy saving, and meets the requirements of contemporary green life.

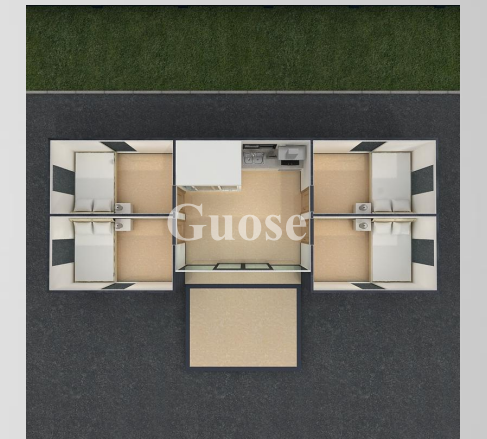

Residential containers can be single or multiple combinations to meet different needs.

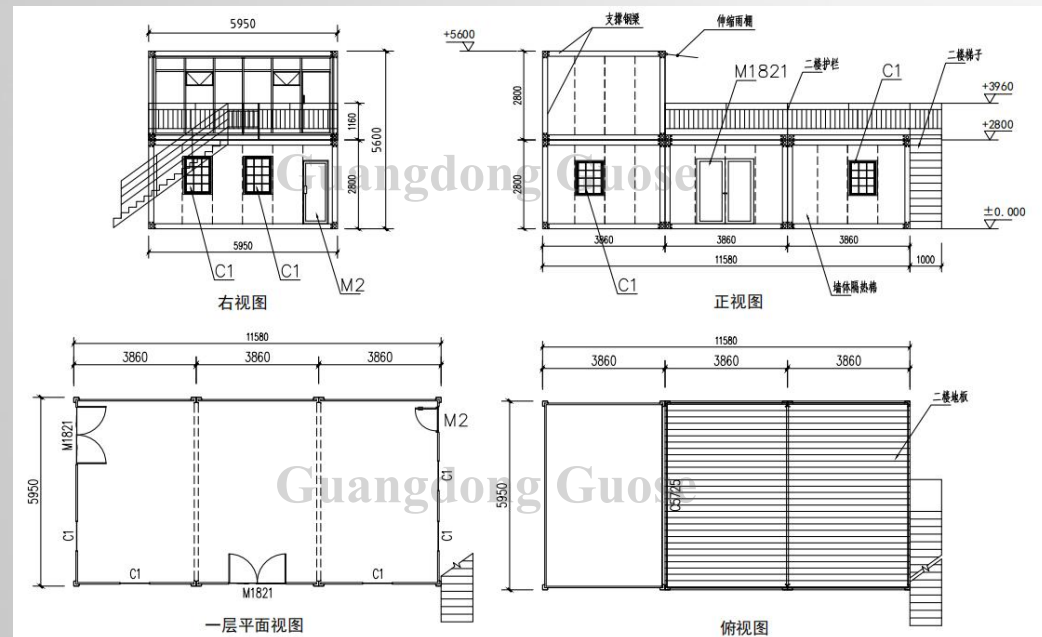
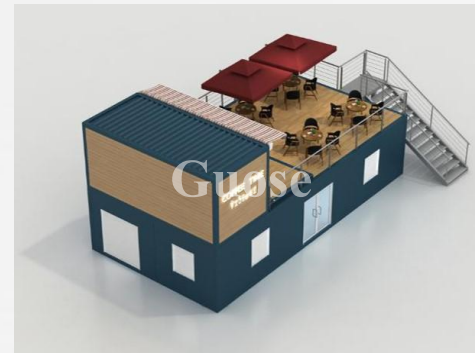

## CATERING SHOPS

➤ Several boxes are merged together in the way of connecting boxes to maximize the use of space efficiency. Using the space of the second-story balcony can accommodate more people. The exterior walls are glass, metal carved panels, and bamboo and wood fiber integrated wall panels. Wait for different options.

➤ Different exterior wall panel renderings



▶ **Three View**

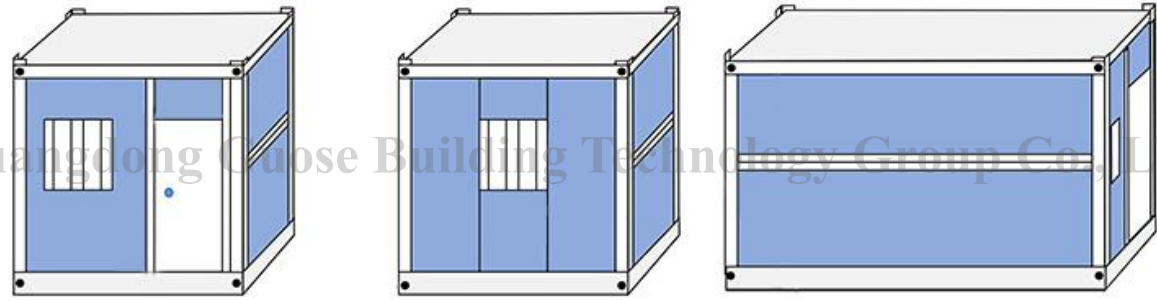

Front view

Rear view

Side view

▶ **Installation process**

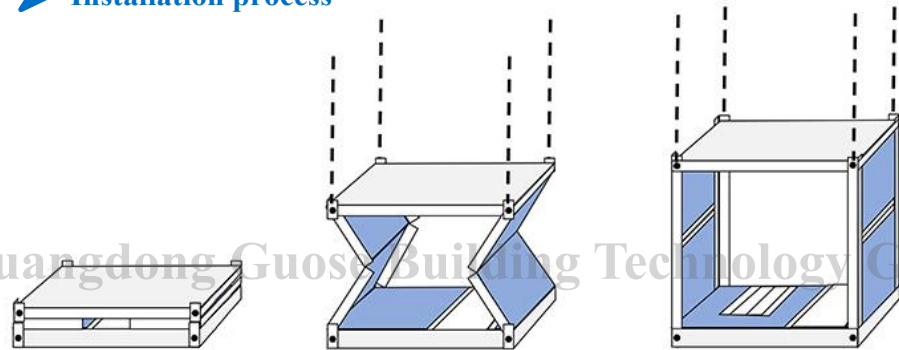

1. The cabinet is in a fully folded state.

2. Hang the hook into the upper lifting hole and lift it up steadily, and the box body will gradually unfold.

3. At this time, the frame around the box is fully unfolded, just lift the two front and back walls at the bottom and push it up. **(Be careful to remove the hook after all the cabinets are installed)**



**PROJECT**



